

Ferienhaus Weberhof

farm, farmhouse in Hopfgarten im Brixental



88 %

87 Ratings



Penningdörfel 15 · A-6361 Hopfgarten im Brixental · stefan.ehammer@aon.at · +43 660 7087705
Additional information at <https://www.weberhof.com/>



Ferienregion Hohe Salve
6300 Wörgl, Innsbrucker Str. 1
AUSTRIA

Telefon: +43 57507 7000
Fax: +43 57507 7020
info@hohe-salve.com
www.hohe-salve.com

UID: ATU44549501
Gerichtsstand: Bezirksgericht Kufstein
Raiffeisenbank Wörgl
IBAN: AT64 3635 8000 0068 9315 / BIC: RZTIAT22358

Ferienhaus Weberhof

farm, farmhouse in Hopfgarten im Brixental

Our annexe and our farm are situated on a plateau at approx. 830 m above sea level in a quiet and sunny mountain environment. The Almhütte annexe has a large bedroom, 2 separate bedrooms and a spacious living and dining area. Our adjoining house is an ideal starting point for many hikes and bike tours, free pony rides for children (under parental supervision), horseback riding (we are not an official riding school!), carriage rides on request and winter toboggan evenings and much more. Use of the natural pond only possible in the summer months after consultation.

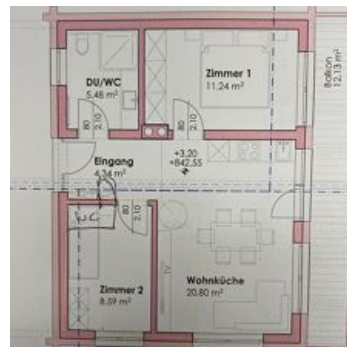
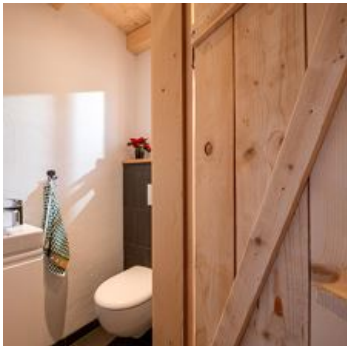

right at the cross-country ski trail · private setting · on the hiking path · quiet location · near the forest · meadowlands



Ferienregion Hohe Salve
6300 Wörgl, Innsbrucker Str. 1
AUSTRIA

Telefon: +43 57507 7000
Fax: +43 57507 7020
info@hohe-salve.com
www.hohe-salve.com

UID: ATU44549501
Gerichtsstand: Bezirksgericht Kufstein
Raiffeisenbank Wörgl
IBAN: AT64 3635 8000 0068 9315 / BIC: RZTIAT22358

Rooms and Apartments

Current Offers

Apartment, bath, toilet, 2 bed rooms



1-4 Personen · 2 Bedrooms · 63 m²

The 63m² annexe, our "Almhütte" consists of a large bathroom, two toilets, two separate bedrooms, a spacious living / dining area and kitchen with large flat screen TV. Bedroom 1 has a large double be...

ab
€ 140,00

per apartment on 10.11.2024

TO THE OFFER

Conditions

Pets are not welcome.

Use of the swimming pond is included.

There is a sauna in the Weberhof farmhouse, which can be used on request and for a fee.

Ferienhaus Weberhof

farm, farmhouse in Hopfgarten im Brixental

Penningdörfel 15

A-6361 Hopfgarten im Brixental

Email: stefan.ehammer@aon.at

Phone: +43 660 7087705

<https://www.weberhof.com/>



Ferienregion Hohe Salve
6300 Wörgl, Innsbrucker Str. 1
AUSTRIA

Telefon: +43 57507 7000
Fax: +43 57507 7020
info@hohe-salve.com
www.hohe-salve.com

UID: ATU44549501
Gerichtsstand: Bezirksgericht Kufstein
Raiffeisenbank Wörgl
IBAN: AT64 3635 8000 0068 9315 / BIC: RZTIAT22358